



High quality and reasonable prices!

Domestic fans

Ventilation grilles

Access doors

- Convenient and safe packing
- Marketing support for sales partners
- One retail price throughout Ukraine
- Prompt delivery of wholesale quantities of goods to any city of Ukraine

Selection method for domestic fans

Required data for fan selection:

1. Calculate the total room volume using a simple formula: Length x Width x Height = room volume [m³]

$$L * W * H = V \text{ m}^3$$

2. Premise type for calculation of the exchange rate per hour.

Each premise has norms for air exchange rate, i.e. air volume to be removed from the room.

Calculation of air exchange rate:

$$\begin{aligned} & \text{(space volume [m}^3\text{])} \\ & \times \\ & \text{(air exchange rate per hour)} \\ & = \\ & \text{ventilation unit} \\ & \text{capacity [m}^3\text{/h]} \end{aligned}$$

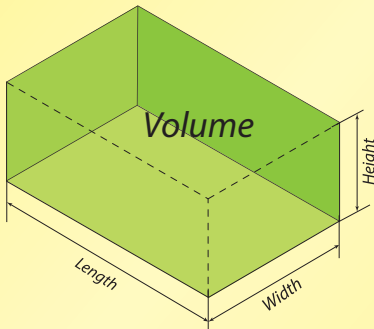

Room type	Air exchange rate per hour	Required air capacity [m ³ /h]
Bathroom (from 8 to 16 m ²)	6-10	90-300
Toilet (from 2 to 8 m ²)	6-8	90-190
Kitchen (from 8 to 18 m ²)	6-12	100-320
Cellar (from 4 to 8 m ²)	6-8	90-190
Living room or bedroom (from 15 to 25 m ²)	4-8	90-300

Domestic fans



Domovent VKO

Designed for inline mounting

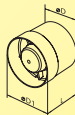

Model	Voltage [V] at 50 Hz	Power [W]	Air capacity [m ³ /h]	Noise level at 3 m [dBA]	Dimensions [mm]		
					Ø D	Ø D1	L
Domovent 100 VKO	220-240	14	105	37	100	104	91
Domovent 125 VKO	220-240	16	188	38	125	129	93
Domovent 150 VKO	220-240	24	290	40	150	154	108



Domvoent S/S1

Equipped with an insect screen

Options: timer (ST/S1T)
pull cord switch (SV/S1V)

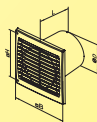

Model	Voltage [V] at 50 Hz	Power [W]	Air capacity [m ³ /h]	Noise level at 3 m [dBA]	Dimensions [mm]			
					Ø D	B	H	L
Domovent 100 C/C1	220-240	14	94	39	100	150	120	108/93
Domovent 125 C/C1	220-240	16	179	44	125	176	140	114/96
Domovent 150 C	220-240	24	286	39	150	205	165	132



Domvoent TISHA

Axial extract fans with low noise level and power consumption

Variants: pull cord switch (V)

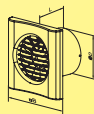

Model	Voltage [V] at 50 Hz	Power [W]	Air capacity [m ³ /h]	Noise level at 3 m [dBA]	Dimensions [mm]		
					Ø D	B	L
Domovent Tisha 100	230	8	90	29	99	150	79
Domovent Tisha 125	230	18	160	34	123,5	180	85
Domovent Tisha 150	230	28	255	35	148	205	112

Domestic fans



Domovent VNL

Centrifugal fan
Integrated filter
Low noise level

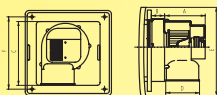

Model	Voltage [V] at 50 Hz	Power [W]	Air capacity [m ³ /h]	Noise level at 3 m [dBA]	Dimensions [mm]					
					A	B	C	D	E	F
Domovent 100 VNL	220	22	100	32	125	40	195x195	100	265x265	220x220



Domovent VV/VVR

Equipped with automatic louvers
The VVR model has a reversible motor

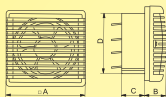

Model	Voltage [V] at 50 Hz	Power [W]	Air capacity [m ³ /h] (in reversible mode)	Noise level at 3 m [dBA]	Dimensions [mm]			
					∅ D	A	B	C
Domovent VV/VVR 180	220-240	25	212 (176)	31	177	230	65	87
Domovent VV/VVR 180	220-240	30	455 (290)	32	237	295	74	85
Domovent VV 230	220-240	29	455 (290)	32	237	295	74	85

Axial fan (industrial)



Domovent VKOM

Designed for inline mounting
Made of galvanised steel

Voltage: 230 V / 50 Hz

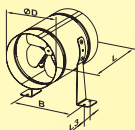

Model	Power [W]	Air capacity [m ³ /h]	Noise level at 3 m [dBA]	Dimensions [mm]			
				∅ D	B	L	L3
Domovent VKOM 150 Z	36	200	33	162	183	220	30
Domovent VKOM 200 Z	43	405	32	208	228	220	30
Domovent VKOM 250 Z	68	1070	48	262	283	270	30
Domovent VKOM 315 Z	110	1700	54	315	337	278	40

Reversible energy regeneration ventilator

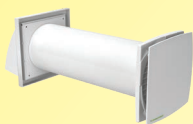

Domovent SOLO

Dimensions [mm]				
Ø D	B	B1	L	L2
103	150	153	300-580	84

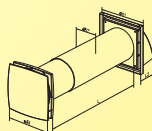

✓ Purpose

- Provide fresh air supply to the room.
- Remove stale air outside.
- Clean air of dust and insects.
- Prevent high indoor humidity and mold formation.
- Protect from outdoor noise.
- Regenerate heat and ensure indoor humidity balance.
- Reduce costs for heating in winter and air conditioning in summer.
- Have low energy demand.

✓ Functioning

- Energy regeneration is provided due to the reversible operation of the ventilator in two cycles:

CYCLE I. Warm stale extract air from the room flows through the ceramic regenerator. The regenerator absorbs heat and humidity. In 70 seconds after warming up the regenerator the ventilator automatically goes to the supply mode.

Cycle II. Fresh intake air from outside flows through the ceramic regenerator, absorbs accumulated moisture and heat from the heat regenerator. In 70 seconds after cooling of the regenerator, the ventilator goes to the extract mode and the cycle starts from the beginning.

- Changeover between supply and extract modes takes place each 70 seconds.

	SOLO RA1-35A-9 R		SOLO RA1-35-R R	
Speed	1	2	1	2
Voltage [V] / 50 (60) Hz	230			
Power consumption [W]	1.43	1.92	1.36	1.89
Maximum current consumption [A]	0.032	0.034	0.031	0.034
Maximum air flow [m ³ /h]	23	35	30	46
Sound pressure level at 3 m [dBA]	27	32	27	32
Max. transported air temperature [°C]	-30 up to + 50			
Regeneration efficiency	≤ 75		≤ 85	
Regenerator material	Aluminium		Ceramics	
SEC class	A		A	
Ingress Protection	IP 24			

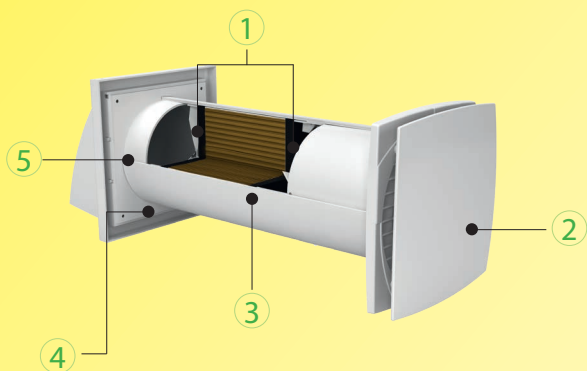

- 1 Filter.** Cleans the air flow of dust and foreign particles. Prevents contamination of the regenerator.
- 2 Fan with reversible motor.** The fan rotation generates air flow. Equipped with a decorative grille.
- 3 Regenerator.** Enables extract air heat regeneration for warming up of supply air.
- 4 Telescopic air duct.**
- 5 Outer ventilation hood.** Prevents ingress of water and foreign objects into the ventilator.

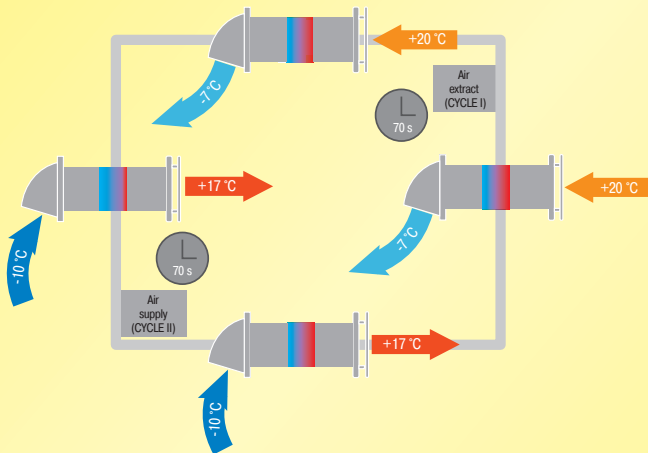

✓ Ventilator mounting

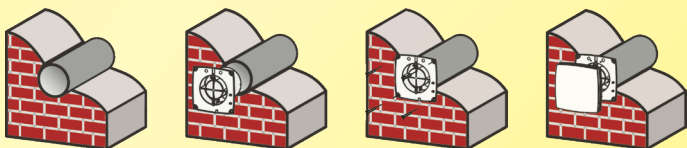

Air supply and exhaust grilles



Square grilles

Equipped with an insect screen

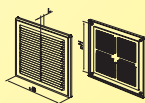

Model	Dimensions [mm]		
	□ B	□ H	L
DV 100s	154	110	15
DV 150s	204	179	16



Rectangular grilles

Equipped with an insect screen

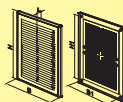

Model	Dimensions [mm]				
	H	B	L	H1	B1
DV 125s	251	182	16	226	157



Rectangular grilles

Equipped with an insect screen



Model	Dimensions [mm]		
	H	B	L
DV 125-1s	238	170	8
DV 150-1s	192	192	8

Colour:

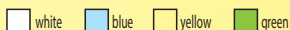

Single-element ventilation grilles



Square grilles

Equipped with an insect screen

Installation options: self-driving screws, fixing lugs (modification M) or silicon

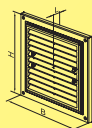

Model	Dimensions [mm]		
	H	B	L
DV 150x150s	150	150	11
DV 175x175s	175	175	11
DV 205x205s	205	205	11
DV 250x250s	250	250	11
DV 300x300s	300	300	11
DV 350x350s	350	350	11



Rectangular grilles

Equipped with an insect screen

Installation options: self-driving screws, expansion pegs or silicon



Model	Dimensions [mm]		
	H	B	L
DV 215x175 / DV 215x175 M	215	175	11
DV 250x180 / DV 250x180 M	250	180	11
DV 295x160 / DV 295x160 M	295	160	11
DV 300x205 / DV 300x205 M	300	205	11

Air supply and exhaust grilles

Round ventilation grilles

Equipped with an insect screen

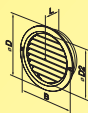

Model	Dimensions [mm]			
	L	B	Ø D1	Ø D
DV 100 bV	29	118	100	128
DV 125 bV	29	148	125	160
DV 150 bV	29	176	150	200

Colour:



white



brown

Kitchen ventilation grille

Used for exhaust ventilation

Equipped with an insect screen and additional grille

Coupled to Ø100 mm rigid air ducts

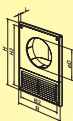

Model	Dimensions [mm]					
	B	H	B2	H2	Ø D	L
DV 100 K	182	252	160	226	100	10

Colour:



white



blue



yellow



green

Door ventilation grilles



Model	Minimum door panel thickness [mm]	Dimensions [mm]	
		H	L
DV 350	32	130	368

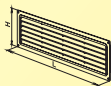

Model	Minimum door panel thickness [mm]	Dimensions [mm]	
		H	L
DV 430/2	32	91	453

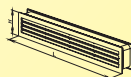

Model	Minimum door panel thickness [mm]	Dimensions [mm]	
		H	L
DV 440/2	37	120	460

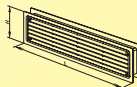

Model	Minimum door panel thickness [mm]	Dimensions [mm]	
		H	L
DV 450	32	124	462

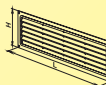

Colour:



white



beige



brown



light oak



grey marble



white marble



Model	Minimum door panel thickness [mm]	Dimensions [mm]			
		Ø D	Ø D1	Ø D2	L
DV 52/2 bV	37	56	40	26	41.5

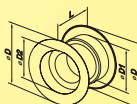

Colour:



white



beige



brown



light oak

Plastic access doors

Provide quick access to concealed construction units and communications.

Wall or ceiling mounting with mortar or adhesives.

Designed for application in humid rooms.

L2 model has two-leaved door design that enables total access to concealed units and communications.



Model	Dimensions [mm]						
	H	B	H1	B1	H2	L	B2
L 100x100	137	137	93	93	98	25	98
L 150x150	167	167	123	123	147	25	147
L 150x200	217	167	173	123	197	25	147
L 150x300	317	167	273	123	297	25	147
L 200x200	217	217	173	173	197	25	197
L 200x250	267	217	223	173	247	25	197
L 200x300	317	217	273	173	297	25	197
L 200x400	417	217	373	173	397	25	197
L 250x250	267	267	246	246	247	25	247
L 250x300	347	267	303	223	327	25	247
L 250x400	417	267	373	223	397	25	247
L 300x300	317	317	273	273	297	25	297
L 300x400	417	317	373	273	397	25	297
L 300x500	517	317	473	273	497	25	297
L 300x600	617	317	573	273	597	25	297
L 400x500	517	417	473	373	497	25	397
L 400x600	617	417	573	373	597	25	397

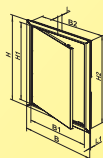

Model	Dimensions [mm]						
	H	B	H1	B1	H2	L	B2
L2 300x300	317	288	273	244	297	25	268
L2 400x400	416	388	372	344	397	25	370

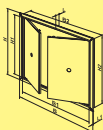

Model	Dimensions [mm]						
	H	B	H1	B1	H2	L	B2
LPV 200x300	317	217	273	173	296	19.5	196

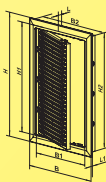

Plastic access doors



Model	Dimensions [mm]						
	H	B	H1	B1	H2	L	B2
LMZ 150*150	186.5	186.5	146.5	146.5	148.1	25	148.1
LMZ 150*200	236.5	186.5	196.5	146.5	198.1	25	148.1
LMZ 150*250	286.5	186.5	246.5	146.5	248.1	25	148.1
LMZ 150*300	336.5	186.5	296.5	146.5	298.1	25	148.1
LMZ 200*200	236.5	236.5	196.5	196.5	198.1	25	198.1
LMZ 200*250	286.5	236.5	246.5	196.5	248.1	25	198.1
LMZ 200*300	336.5	236.5	296.5	196.5	298.1	25	198.1
LMZ 200*400	436.5	236.5	396.5	196.5	398.1	25	198.1
LMZ 250*250	286.5	286.5	246.5	246.5	248.1	25	248.1
LMZ 250*300	336.5	286.5	296.5	246.5	298.1	25	248.1
LMZ 300*300	336.5	336.5	296.5	296.5	298.1	25	298.1
LMZ 300*400	436.5	336.5	396.5	296.5	398.1	25	298.1
LMZ 300*500	536.5	336.5	496.5	296.5	498.1	25	298.1
LMZ 300*600	636.5	336.5	596.5	296.5	598.1	25	298.1
LMZ 350*350	386.5	386.5	346.5	346.5	348.1	25	348.1
LMZ 400*400	436.5	436.5	396.5	396.5	398.1	25	398.1
LMZ 400*500	536.5	436.5	496.5	396.5	498.1	25	398.1
LMZ 400*600	636.5	436.5	596.5	396.5	598.1	25	398.1
LMZ 500*500	536.5	536.5	496.5	496.5	498.1	25	498.1
LMZ 500*600	636.5	536.5	596.5	496.5	598.1	25	498.1
LMZ 600*600	636.5	636.5	596.5	596.5	598.1	25	598.1

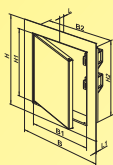

Mounting flange with plate



Facilitates connection to air ducts
Equipped with quick installation with fixing lugs

Model	Dimensions [mm]			
	H	B	Ø D	L
DFK 100	185	169	100	34
DFK 120	185	169	120	34
DFK 125	185	169	125	34

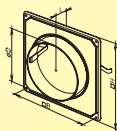



Domovent products are used:

for the bathroom



for the garage

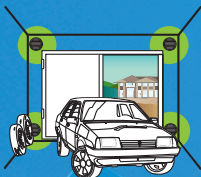

for the kitchen



for heat transfer from a radiator



VENTILATION SYSTEMS, Private Joint-Stock Company
 36, Sobornosti str., Boyarka, Kyiv region, Ukraine, 08150
 Tel. / Fax: (044) 406-36-27 / (044) 406-07-50 multi-drop
 Free counseling centre: **0-800-501-74-80**

(calls from fixed telephone lines within Ukraine are free)

sale@vents.kiev.ua

www.domovent.ua / www.ventilation-system.com

